

Wednesday, January 13, 2021

Introduction of the Multi-Function-Display for the Compact Series (CS200) BMS Battery System ("MFD" Gage)

Description: a hard-mounted display to provide State of Charge, State of Health and Diagnostic Code data. A single display will connect to 1 or more batteries operating in parallel.

Current Battery Compatibility: GTX12V315A-E2107-CS200 GTX12V320A-E2107-CS200-UL

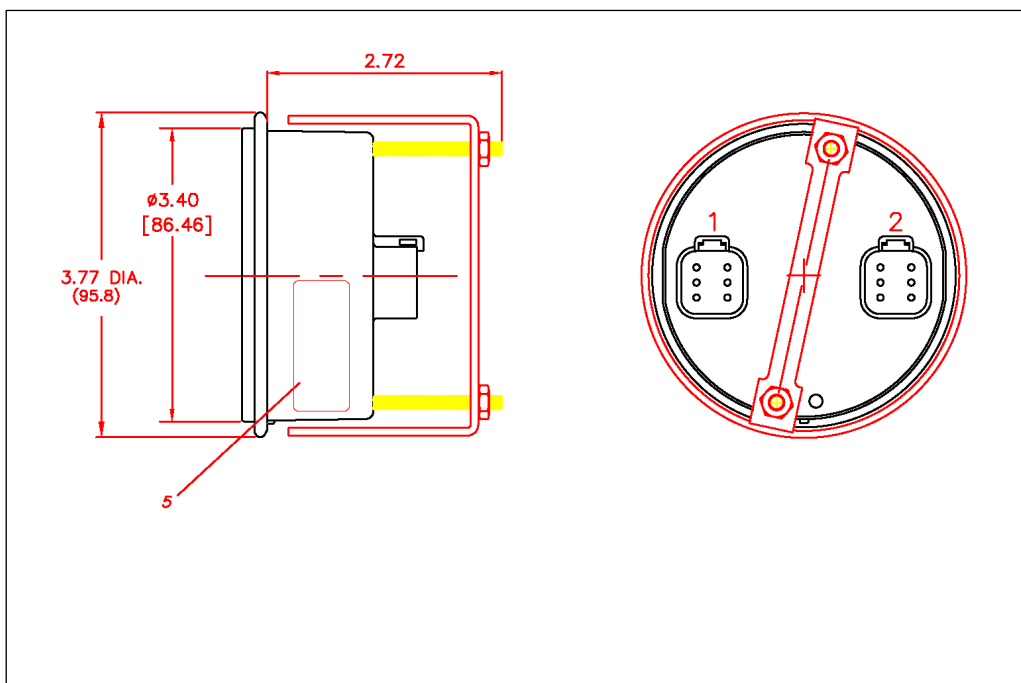
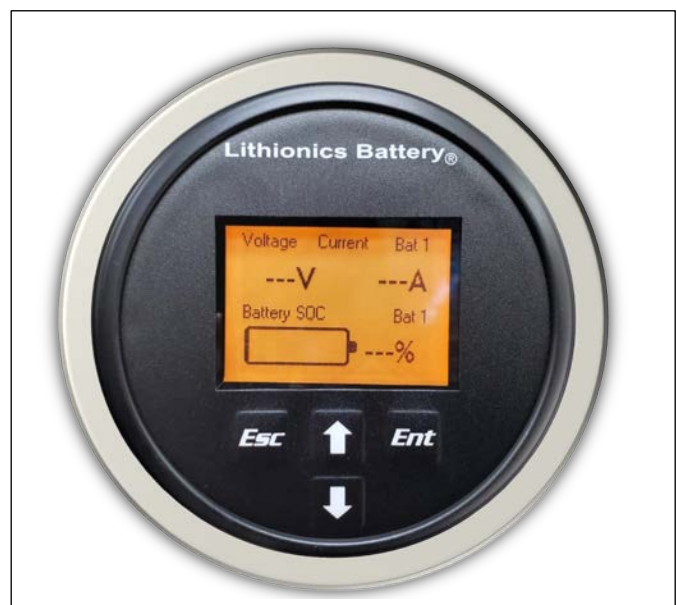

Lithionics Battery®

Voltage 13.5V
Current +149A
Battery SOC 98%

ESC



Ent

MAX TORQUE
60in-lbs/6.8N-m



CAUTION
DO NOT STEP
OR STAND ON
THIS BATTERY.

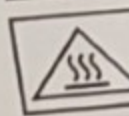

CAUTION
SURFACE MAY
BE HOT.

Rechargeable, LiFePO4
12.8V
250A at 75 Degrees F
200 Amps
<1200A (1.3s)
315Ah / 4,032Wh
IP66
0 to 55C (32 to 131F)
-20 to 55C (-4 to 131F)
-20 to 25C (-4 to 77F)

is Current
arge Current





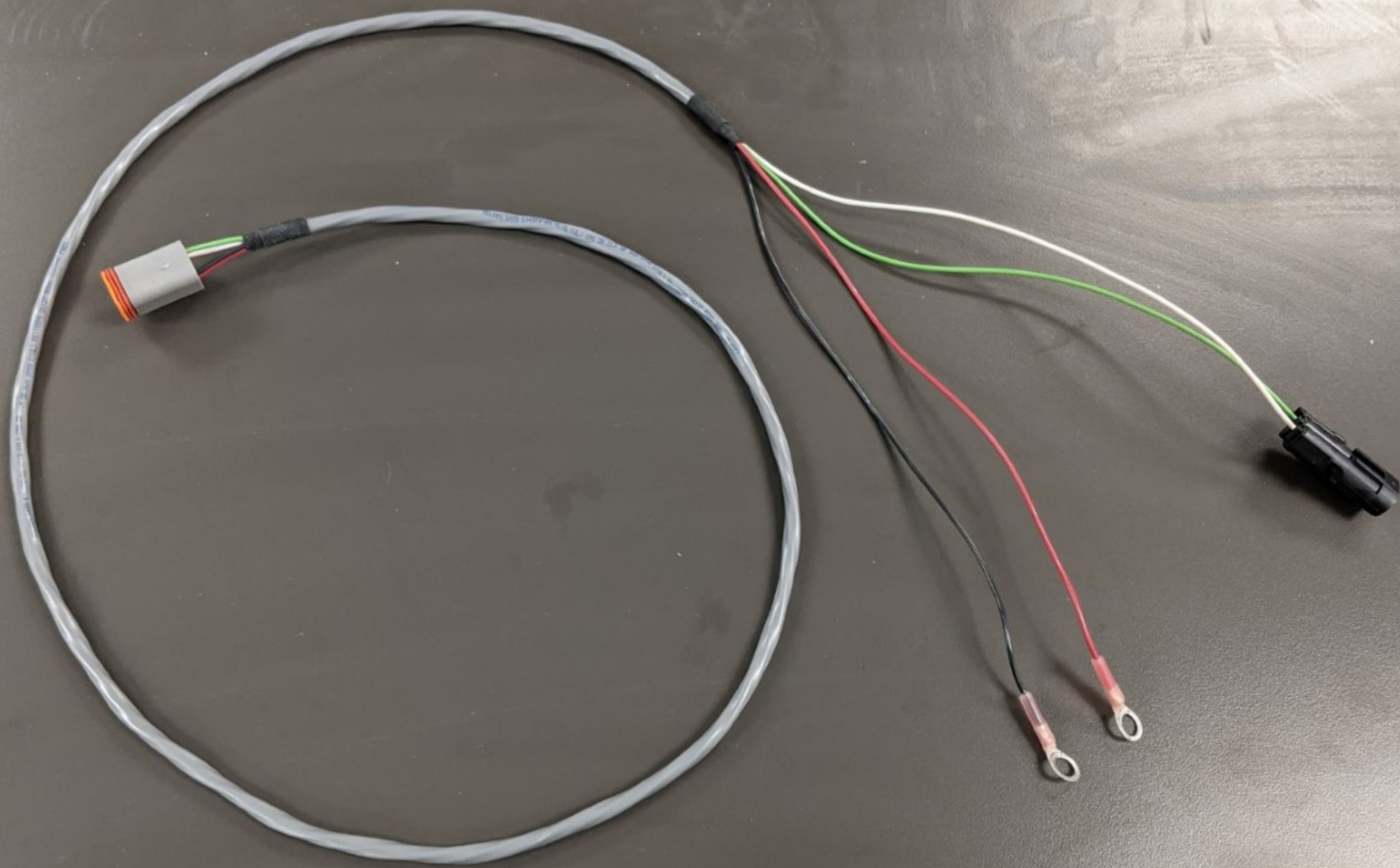





DERIVED FROM OUR BEST-IN-CLASS DDBI™

MINI MULTI-FUNCTION DISPLAY-J1939



Same rugged platform as DDBI™

MAIN MENU



50-stored CAN-bus parameters

Esc **▲**

Intuitive controls



Integral sealed connectors



More I/O than comparable units



IP 67 sealed, ideal for severe-duty



Processes Digital or Analog Inputs





Replaces All Round Gauges

IDEAL FOR CONSTRUCTION, AG, INDUSTRIAL, SPECIALTY

Mini-MFD is a self-contained, multi-function, J1939 display based on Maxima's best-in-class Direct Data-Bus Instruments (DDBI) line. Designed for severe-duty environments, it's totally sealed. It comes with 50-stored parameters for easy program-ming and processes digital and analog inputs such as fuel level. And, it fits a 3-3/8" tach opening for easy installation.

BOTTOM-LINE: MORE FEATURES & BENEFITS

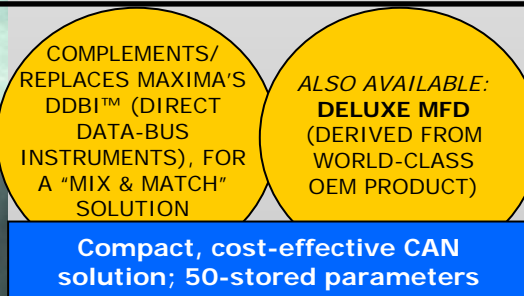
- ✓ Fits tach opening, pin-for-pin compatible with DDBI™ & other displays
- ✓ Larger easy-to-read LCD, with amber LED backlighting
- ✓ 4-tactile switches, easily engaged, sealed, LED backlit; with intuitive menu control
- ✓ LED status indicators—amber alert, red warning
- ✓ 4-digital or analog inputs; supports non-bus functions such as fuel level
- ✓ Easy-to-install, with integral sealed connectors
- ✓ Weather-resistant, engineering resin enclosure with built-in sunshield
- ✓ Wide operating temperature & voltage ranges



COMPLEMENTS/ REPLACES MAXIMA'S DDBI™ (DIRECT DATA-BUS INSTRUMENTS), FOR A "MIX & MATCH" SOLUTION

ALSO AVAILABLE: **DELUXE MFD** (DERIVED FROM WORLD-CLASS OEM PRODUCT)

Compact, cost-effective CAN solution; 50-stored parameters





Mini MFD

SPECIFICATION SHEET



DESCRIPTION:

Mini MFD is a compact multi-function display featuring an electronic CAN-bus architecture and platform derived from our standard Direct Data-Bus Instrument (DDBI™) tachometer. It provides critical operating information to the user to ensure optimal performance. Sealed push-buttons offer improved tactile feel. Designed for severe-duty, the unit is configurable via intuitive menu control, with 50 stored parameters.

FEATURES:

- ▶ LCD, 128 x 96 resolution, viewing area 42 x 29 mm
- ▶ Integrated keypad with 4 tactile switches, sealed
- ▶ Intuitive menu control: Escape, Up, Down, Enter
- ▶ 50 stored standard parameters (per SAE J1939)
- ▶ Amber LED backlighting for LCD
- ▶ White LED backlighting for switches
- ▶ 2 status indicators, LED, amber & red
- ▶ Configurable for digital & analog inputs
- ▶ Switched output capability—controls accessories
- ▶ Password-protected for initial set-up & configuration

INPUTS/OUTPUTS:

- ▶ 4 configurable digital or analog inputs
- ▶ 1 high-side switch (e.g. to drive buzzer)
- ▶ 1 low-side switch (e.g. to drive a relay)
- ▶ 1 ignition input
- ▶ 1 battery input
- ▶ 1 ground for analog sender
- ▶ 1 CAN channel

COMMUNICATION LINK:

- ▶ CAN interface, SAE J1939 protocol

PIN ASSIGNMENTS:

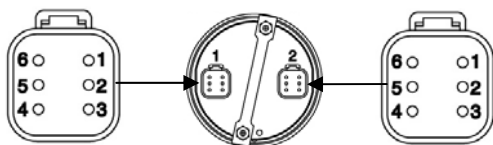

Connector 1: Pin/Function	Connector 2: Pin/Function:
1: Battery (Power Supply)	1: Ignition (Key switch)
2:Ground (Power Supply)	2: Digital/analog 2 (Input)
3:Digital/analog 1 (Input)	3:Digital/analog 3 (Input)
4: CAN+ (J1939 interface)	4: Digital/analog 4 (Input)
5:CAN - (J1939 interface)	5: Analog Ground (Sender)
6:Low-side switch (Driver)	6: High-side switch (Driver)



Derived from Maxima's Direct Data-Bus Instrument (DDBI™) tachometer/speedometer

ELECTRICAL:

- ▶ System voltage: 12/24V nominal, 9-32 VDC range
- ▶ Electrical protection: Reverse polarity, transients including load-dump, over-voltage & ESD.

ENVIRONMENTAL:

- ▶ Operating temperature: -30°C to +85°C
- ▶ Storage temperature: -55°C to +85°C
- ▶ Sealing: IP 67; Anti-fog coated safety plastic lens
- ▶ Compliant: SAE standards for vibration & salt spray

PHYSICAL CHARACTERISTICS:

- ▶ Weight: 0.32 lbs (0.15 kg)
- ▶ Mounting: Panel installation via bracket
- ▶ Same size as standard tachometer (3-3/8" diameter)
- ▶ Engineering resin enclosure, reinforced, UV resistant

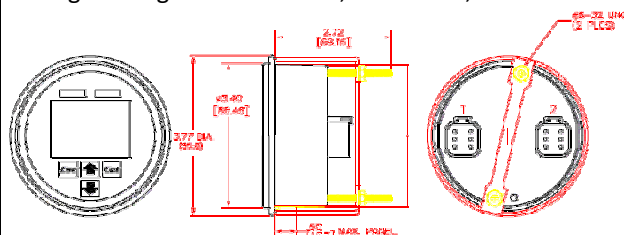

CONNECTORS:

- ▶ 2 6-pin Deutsch DT Series connectors, sealed (IP 67)
- ▶ Pin-for-pin compatible with competitor's unit (Ask Maxima for more details)

CONFIGURATION/OPERATION:

Configurable via menu selections. Displays various Performance and Status Pages via one or two lines of text and/or icons. Use "Esc" (Escape), Up, Down or "Enter" to navigate set-ups and choice of screens. Auto-scroll option enables continuous looping. Unit can be set up for English, Spanish or French. Analog input can be configured for resistance or voltage.

YOUR SIX-SIGMA INSTRUMENTATION & CONTROLS PARTNER™

Installation Instructions

Mini-MFD™

- Recommended panel hole size is $3.4'' \pm 0.02''$ or $86.4\text{mm} \pm 0.51\text{mm}$.
- Insert the instrument in the panel and place the U-bracket over the mounting studs.
- Install one washer and one nut on each stud over the U-bracket.
- Tighten the nuts (4 to 6 in.-lb.) to secure the instrument.

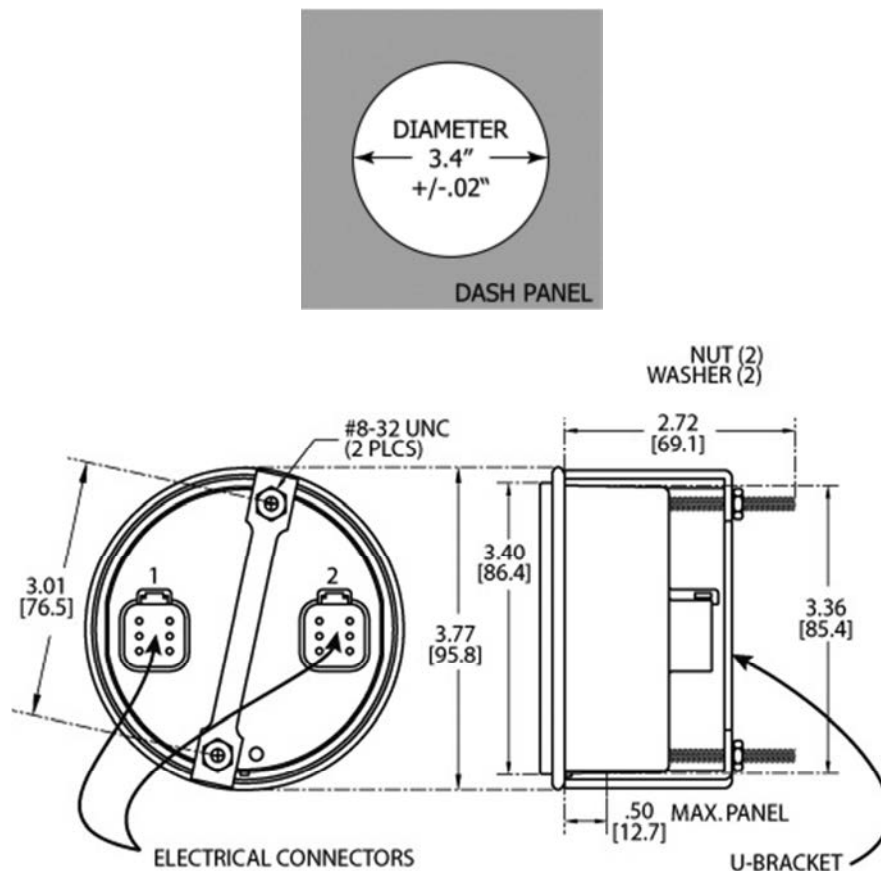

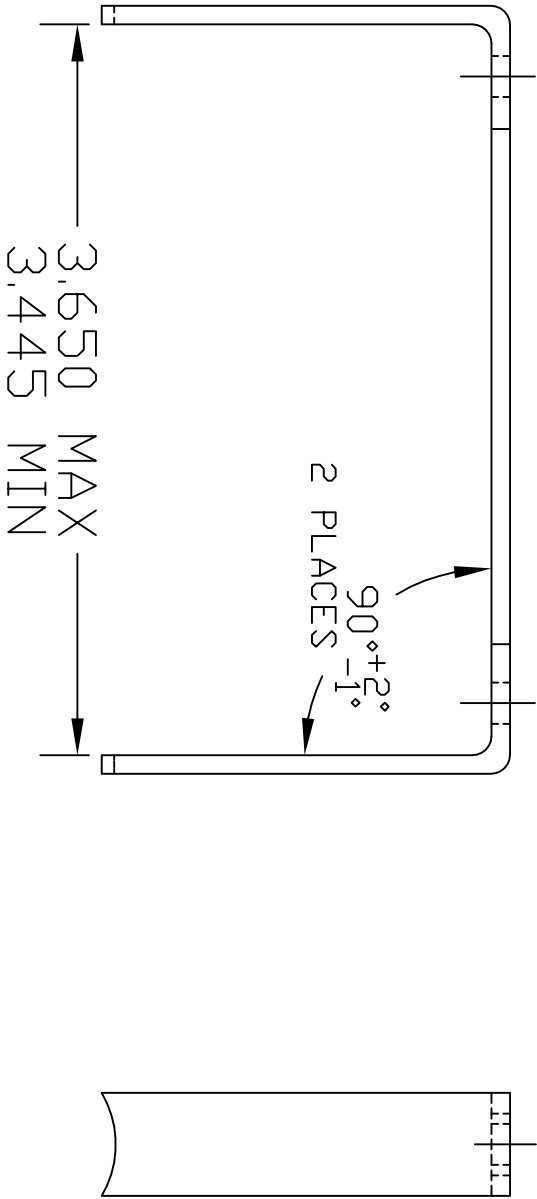
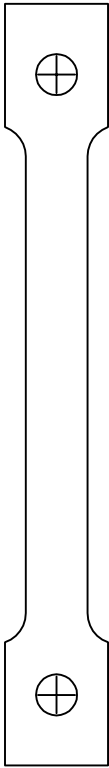

NOTES:

1. USE THIS DRAWING WITH BILL OF MATERIALS.
2. COMMERCIAL ZINC PLATE .00005 - .00015 THK., CHROMATE DIP
IRIDESCENT YELLOW TO OLIVE DRAB

M	REVISE PLATING SPECIFICATIONS COMMERCIAL GRADE PLATING	14643	3/06/01
L	FIRST CAD RELEASE DELETE PARTS LIST, TABLE I REMOVE DIMENSIONS. REV. NOTES: WAS C SIZE, -00,-01,-02. REV AND REDRAWN	12087	3/22/95
REV	DESCRIPTION	ECN	DATE
REVISIONS			
UNLESS OTHERWISE SPECIFIED DIMENSIONS ARE IN INCHES			
TOLERANCES DECIMALS 2 PL ± ~ ANGLES ± ~			
CORNERS SHALL BE ~ RADIUS OR CHAMFER			
CONFIDENTIAL			
This drawing is submitted in confidence for either proposal or inspection purposes only. No license, right or privilege to reproduce the drawing, in whole or in part, or to manufacture or use any article herein shown is granted and any such reproduction or use without the written approval of Maxima Technologies.			
MAXIMA TECHNOLOGIES			
EAST PETERSBURG, PA.			
BRACKET, MOUNTING			
(3.4" TACH / SPEEDO)			
DWN MAJ 3/22/95	SIZE A	DWG. NO. 71217-00	
CHK RCV 3/22/95	A		
APPD RCV 3/22/95	SCALE 1=1	SHEET 1	OF 1